

Optical Splitter

FSC110/116 Series

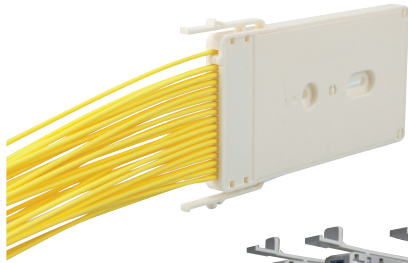

FSC-116 series



FSC-110 series

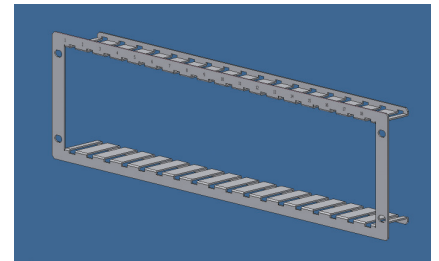
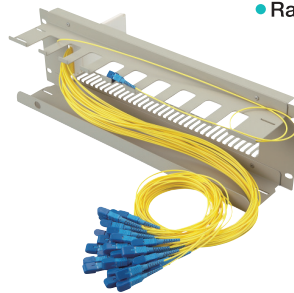

Features & Benefits

- Module design and easy installation
- Compact size and high density
- 19inch rack mountable

Applications

- FTTH optical splitting cabinets and closure
- Rack mount

Specifications

FSC110 splitter

Item	1 × N					2 × N			
	1 × 2	1 × 4	1 × 8	1 × 16	1 × 32	2 × 4	2 × 8	2 × 16	
Fiber	SM 10/125 fiber								
Operating Wavelength (nm)	1290 - 1330, 1480 - 1500, 1530 - 1570								
Insertion Loss(dB) *	≤ 4.3	≤ 8.0	≤ 11.6	≤ 14.9	≤ 18.4	≤ 8.1	≤ 11.7	≤ 15.0	
Uniformity (dB) *	≤ 0.9	≤ 2.0	≤ 1.0	≤ 1.5	≤ 2.0	≤ 2.0	≤ 1.2	≤ 1.5	
Return Loss (dB)	≥ 50								
Dimension (L × W × H mm)	L22 W130 H117		L47 H130 W117		L97 H130 W117		L22 W130 H117		L47 H130 W117

FSC116 splitter

Item	1 × N						2 × N			
	1 × 2	1 × 4	1 × 8	1 × 16	1 × 32	1 × 64	2 × 4	2 × 8	2 × 16	
Fiber	SM 10/125 fiber									
Operating Wavelength (nm)	1290 - 1330, 1480 - 1500, 1530 - 1570									
Insertion Loss(dB) *	≤ 4.3	≤ 8.0	≤ 11.6	≤ 14.9	≤ 18.4	≤ 22.1	≤ 8.1	≤ 11.7	≤ 15.0	
Uniformity (dB) *	≤ 0.9	≤ 2.0	≤ 1.0	≤ 1.5	≤ 2.0	≤ 3.0	≤ 2.0	≤ 1.2	≤ 1.5	
Return Loss (dB)	≥ 50									
Dimension (L × W × H mm)	L9.2 W65 H130					L13.2 W65 H130		L9.2 W65 H130		
Standard Cord Length (m)	1.5 (φ 2mm cordage)									

* same for UPC and APC polish, without connectors

Ordering Information

Product Code

FSC110- X -SC / Y

FSC116- X -SC / Y

Type of Splitter:

- | | |
|-------------------------|-------------------------|
| 1 × 2: 1 × 2 splitter | 1 × 64: 1 × 64 splitter |
| 1 × 4: 1 × 4 splitter | 2 × 4: 2 × 4 splitter |
| 1 × 8: 1 × 8 splitter | 2 × 8: 2 × 8 splitter |
| 1 × 16: 1 × 16 splitter | 2 × 16: 2 × 16 splitter |
| 1 × 32: 1 × 32 splitter | |

Connector Type:

- APC: Angled PC
UPC: UPC